

DPS Slider Retrofit Instructions Extended Glass Kit

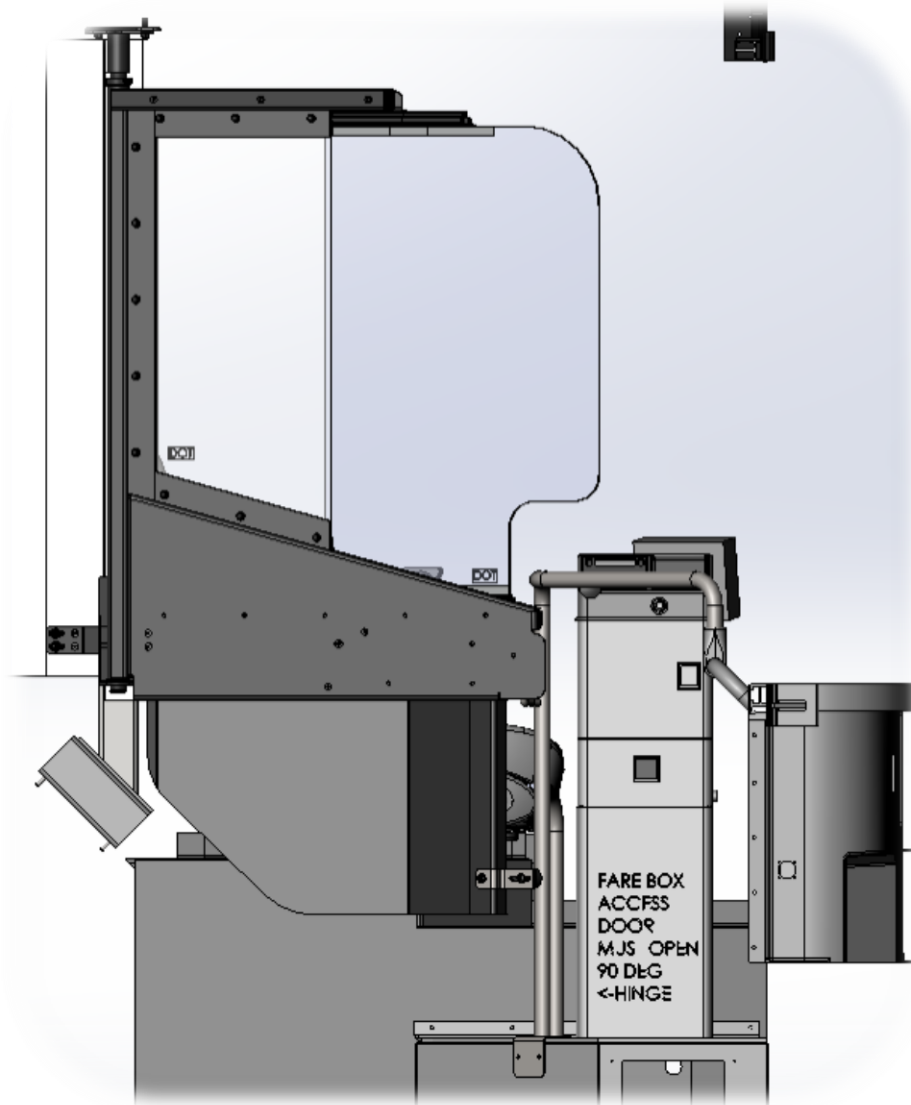



Tools Needed

Drill

7/16" Box Wrench or Ratchet

5/32" Hex Key

T-20 Torx Bit

Phillips Screw Driver or Phillips Drill Bit

**NOTE: DO NOT DISCARD ANY HARDWARE
AS ALL OF THE HARDWARE IS REUSED**

1. Remove the two glass stop plates by using a T-20 Torx bit to remove the 4 screws (2 in each plate) holding the stop plates on.

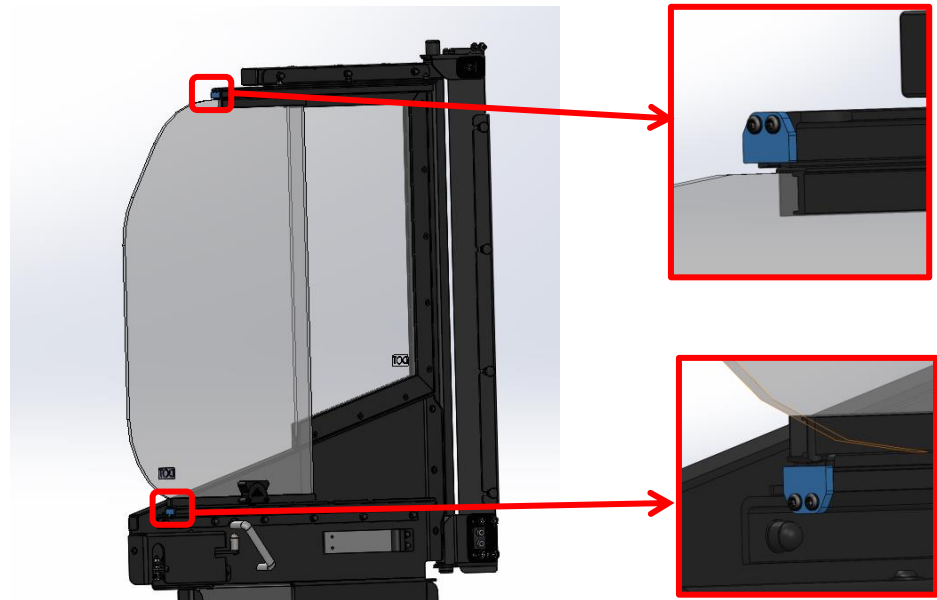

2. Once the plates are removed, remove the glass by releasing the rocker latch and sliding it out of the track.



3. Use a Phillips bit to remove the two screws holding the rocker latch onto the existing glass assembly (If the new glass does not have a rocker latch on).



4. Locate the new extended glass assembly. Reinstall the latch from the old glass using the same hardware that was originally used. Torque to 30 in-lbs.

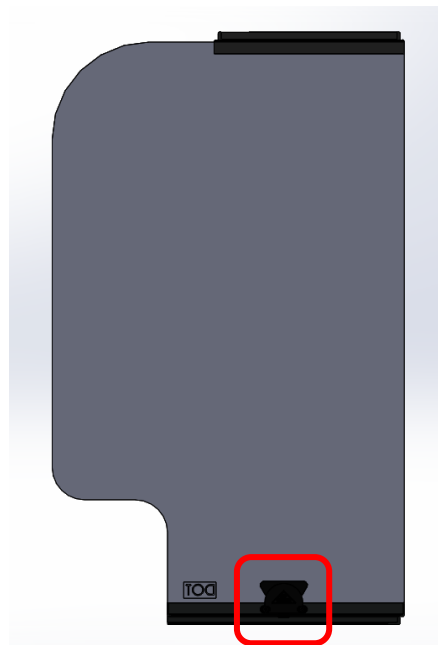

5. Remove the 3 nut covers on top of the upper slider assembly.

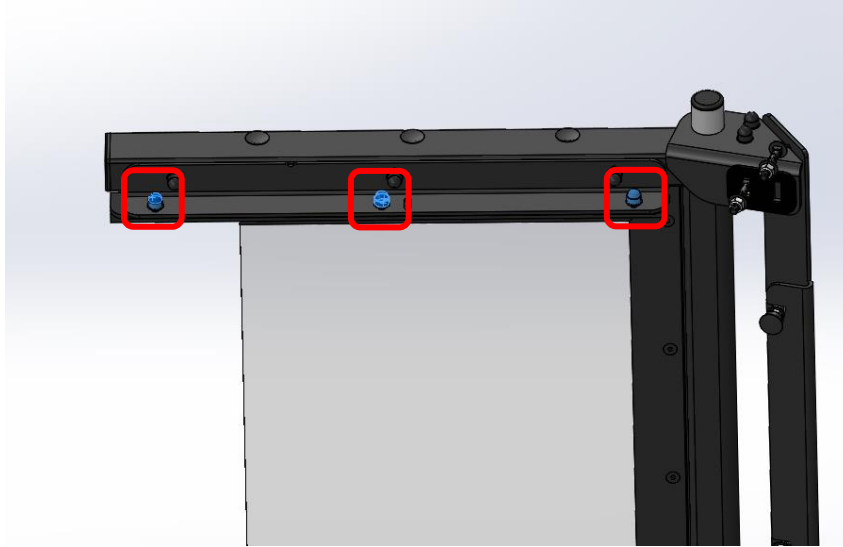

6. Use a 5/32" hex key and a 7/16" wrench or ratchet to remove the 3 nuts and bolts which will allow for removal of the upper slider assembly.

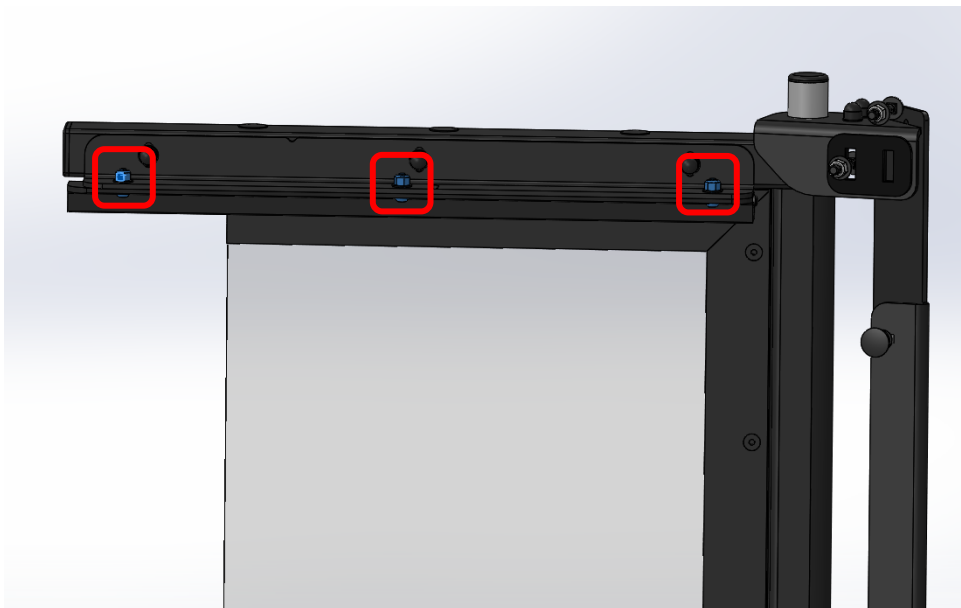

7. Locate the new slider track assembly.

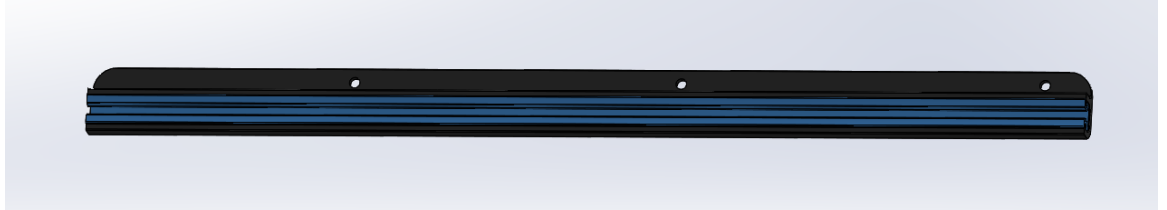

8. Install the new upper slider track assembly in the same way that the old one was installed. Use the original bolts, washers, and nuts. Torque to 75 in-lbs. and replace the nut covers that were removed earlier. (These can be left loose as they may need to be adjusted)

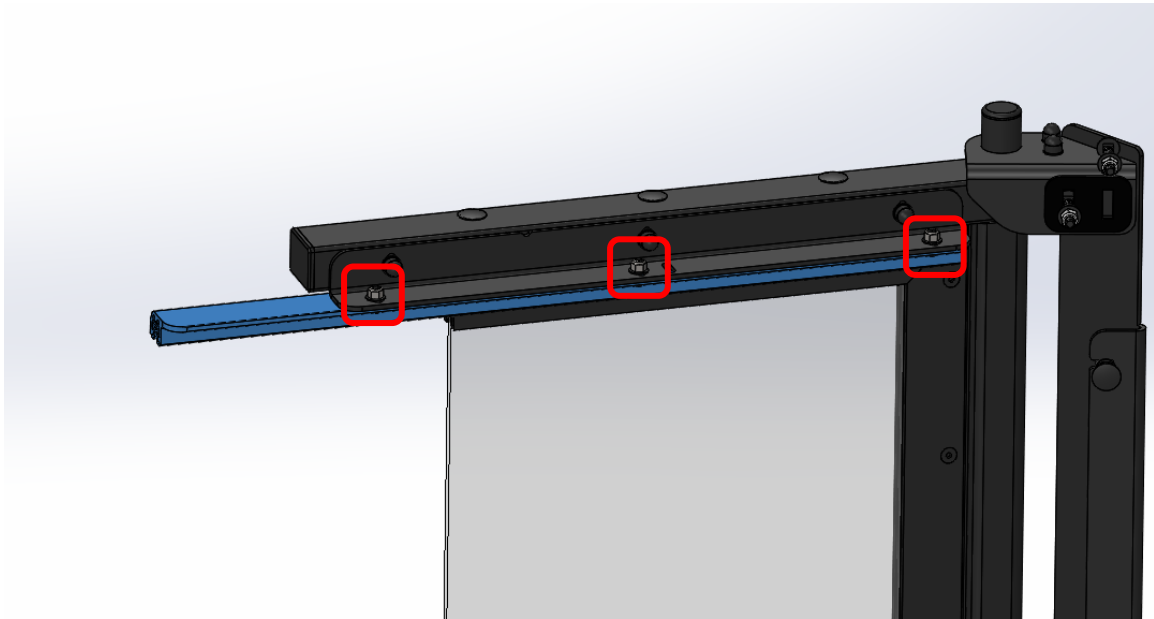

9. Locate the new extended glass with the rocker latch installed. Slide the new glass into the track; make sure the latch is on the driver side of the door.

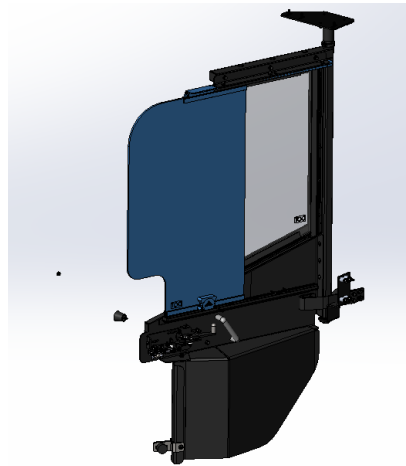

10. Replace the upper and lower slider track plates using the original hardware. Apply Loctite 243 and torque to 23 in-lbs.

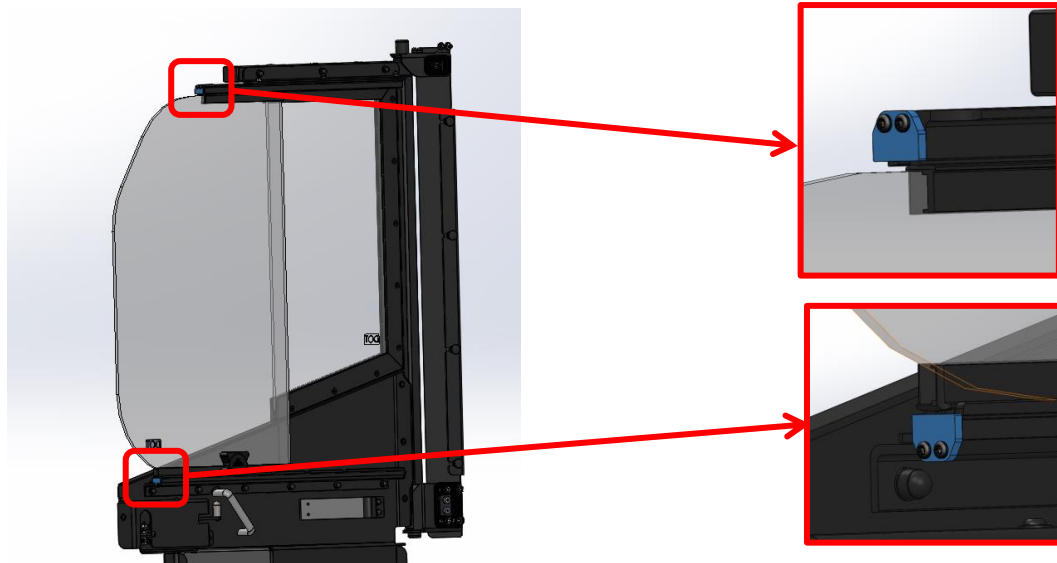

11. Cycle the slider back and forth.
12. Reference the Service and Maintenance Procedure for upper slider track adjustment, if needed. Replace all nut covers once adjustment is complete.
13. Cycle the glass to ensure proper operation. This procedure is complete.