

Consultants:

Signature:

I HEREBY CERTIFY THAT THIS PLAN, SPECIFICATION, OR REPORT WAS PREPARED BY ME OR UNDER MY DIRECT SUPERVISION AND THAT I AM A DULUTH LICENSED ARCHITECT UNDER THE LAWS OF THE STATE OF MINNESOTA.

SIGNATURE: *Gary C. Patrick*
 TYPED OR PRINTED NAME: GARY C. PATRICK
 DATE: 4-11-19 REGISTRATION NO.: 22295

Issues and revisions:

ISSUE LEVEL / REVISION:	DATE:	No.:
BID SET	4/11/2019	
ADDENDUM #2	10/8/2019	AD2

Client:

DULUTH TRANSIT
 AUTHORITY

Project title:

2019 PARTIAL REROOFING
 OPERATIONS CENTER

2402 W MICHIGAN ST.
 DULUTH, MN 55806

Sheet content:

- ROOF PLAN (MAINTENANCE)
- ROOF PLAN NOTATIONS AND SYMBOLS
- KEY PLAN

DATE: 4/11/2019
 CLIENT PROJECT No.: 214706.1
 INSPEC PROJECT No.:
 PROJECT MGR: DM
 DRAWN BY: RJM
 CHECKED BY: DM

Sheet No.:

A1.1

ROOF PLAN NOTATIONS AND SYMBOLS

- (a) AT PARAPET INTERSECTION TO PARAPET OR WALL PROVIDE A ONE-PIECE FULLY SOLDERED SHEET METAL CLOSURE FLASHING
- (b) NEATLY CUT OUT PORTION OF EIFS AND PROVIDE SHEET METAL RECEIVER FLASHING. (SEE DETAIL 1/A6.)
- (c) EXISTING WALL-MOUNTED ANTENNAE AND/OR COMMUNICATION CABLE. REMOVE AND REINSTALL AS NECESSARY TO PROVIDE NEW MATERIALS. MODIFY OR REPLACE MOUNTING BRACKETS. COORDINATE DOWNTIME AND/OR TEMPORARY CONNECTIONS WITH OWNER.
- (d) REMOVE EXISTING BRACKETS AND PROVIDE NEW BRACKETS CUSTOM 12 GA. G.S. TO SUPPORT EXISTING DUCTWORK AT VERTICAL SURFACE ON PARAPET DETAIL WITH LAG SCREWS THROUGH EPDM PAD.
- (e) EXISTING WALL-MOUNTED BRACE AND/OR BRACKET. REMOVE AND REINSTALL AS NECESSARY TO PROVIDE NEW MATERIALS. PROVIDE TEMPORARY SUPPORTS AND MODIFY AS REQUIRED.
- (f) MODIFY WALL-MOUNTED PIPING TO ACCOMMODATE NEW MATERIALS.
- (g) REMOVE OBSOLETE ITEM AND SUPPORTS AND COVER HOLE IN DECK FOR HOLES LESS THAN 13". COVER OPENING WITH 12 GA. G.S. PLATE LAPPED MINIMUM 6" ONTO DECK FASTENED 6" O.C. REPAIR CEILING WITH 5/8" TYPE X GYPSUM BOARD FINISH TO MATCH
- (h) DUCTWORK ABOVE ROOF (HEIGHT VARIES APPROX 2'-0" TO 6'-0") RAISE AS NECESSARY WHEN RAISING CURB ON BUS STORAGE
- AL EXISTING ACCESS LADDER. PROVIDE DOUBLE FLOOD COAT AND EXTRA GRAVEL WITHIN 3'-0" OF LADDER LOCATION. REMOVE LADDER AND DELIVER TO OWNER FOR MODIFICATION/ REINSTALLATION (VERIFY NEW LOCATION).
- HS/BS NEW HEAT/ BOILER STACK CURB AT EXISTING STACK (SEE DETAIL 6/A3)
- 1/2"/FT. TAPERED INSULATION SUMP
 1/8"/FT. TAPERED INSULATION
- MU1 EXISTING MECHANICAL UNIT CURB. PROVIDE 1/2"/FT. TAPERED ISOCYANURATE INSULATION CRICKETS AT HIGH SIDE OF ALL CURBS (SEE DETAIL 3/A3)
- MU2 EXISTING MECHANICAL UNIT CURB. PROVIDE 1/2"/FT. TAPERED ISOCYANURATE INSULATION CRICKETS AT HIGH SIDE OF ALL CURBS (SEE DETAIL 5/A3)
- MU3 NEW MECHANICAL CURB FOR EXISTING MECHANICAL EQUIPMENT (SEE DETAIL 4/A3)
- PP EXISTING PIPE PENETRATION TO REMAIN (SEE DETAIL 5/A5)
- PB NEW PIPE BOX ENCLOSURE AT NEW OR EXISTING LOCATION. CONSOLIDATE NEAR BY MECHANICAL AND ELECTRICAL THROUGH PIPE BOX ENCLOSURE (SEE DETAIL 6/A4)
- RH ROOF HATCH. PROVIDE DOUBLE FLOOD COAT AND EXTRA GRAVEL WITHIN 3'-0" (SEE DETAIL 6/A4)
- RD EXISTING ROOF DRAIN AT EXISTING LOCATION (SEE DETAIL 3/A5)
- ORD EXISTING OVERFLOW ROOF DRAIN AT EXISTING LOCATION (SEE DETAIL 3/A5)
- SC1 EXISTING SLEEPER CURB (SEE DETAIL 7/A4)
- SC2 NEW SLEEPER CURB AT EXISTING SUPPORT LEGS FOR DUCTWORK (SEE DETAIL 7/A4)
- S1 NEW PRIMARY THROUGH-PARAPET SCUPPER WITH DOWNSPOUT AND SHEET METAL SPLASH PAN AT EXISTING LOCATION. (SEE DETAIL 1/A5 & 6/A5)
- S2 NEW PRIMARY FREE-FALL SCUPPER AT NEW LOCATION. (SEE DETAIL 2/A5)
- S3 EXISTING MONOLITHIC CONCRETE SCUPPER. LINE ENTIRE TROUGH WITH UNCURED NEOPRENE AND SHEET METAL. PROVIDE SHEET METAL CAP FLASHING AND ONE-PIECE SHEET METAL CLOSURES AT END OF TROUGH AND AT INTERSECTION WITH EIFS WITH CONTINUOUS SEALANT COMPRESSED WITH FASTENERS AT 8" O.C. (PROVIDE SHOP DRAWINGS)
- STRUCTURAL SLOPE (SLOPES VARY)
- VS EXISTING VENT STACK (SEE DETAIL 4/A5)
- EJ/WEJ EXPANSION JOINT (EJ) WALL EXPANSION JOINT (WEJ). AT ROOF EDGE OR EXPANSION JOINT INTERSECTION. CONTINUE WOOD BLOCKING FULL HEIGHT AND PROVIDE TWO-PIECE SHEET METAL EXPANSION TYPE END ENCLOSURE
- CJ CONTROL JOINT. AT ROOF EDGE CONTINUE WOOD BLOCKING FULL HEIGHT AND PROVIDE SHEET METAL ENCLOSURE.
- WD EXISTING WINDOW AT ROOF/WALL CONDITION (SEE DETAIL 5/A2)
- CHANGE IN PLANE
- E EXISTING CONDUIT FOR FIBER OPTICS. AT END OF CONDUIT NEAR GRID 12. CONDUIT IS OPEN AND FIBER OPTIC CABLES EXIT THE CONDUIT AND ARE COILED ON ROOF SURFACE. MOUNTED TO ROOF EDGE AND CONTINUE TO A POLE AWAY FROM THE BUILDING. TEMPORARILY SUPPORT CABLES DURING INSTALLATION OF NEW MATERIALS.
- G GAS PIPING. MODIFY AS REQUIRED FOR NEW MATERIALS AND SUPPORT WITH PRE-MANUFACTURED PIPE SUPPORTS. (SEE PROJECT MANUAL) OWNER SHALL MAKE CONNECTIONS AT LOCATIONS THAT ARE CURRENTLY DISCONNECTED AND HANDLE TESTING AND FILLING GAS PIPING AFTER ROOFING IS COMPLETED
- ◇ PROVIDE TAPERED INSULATION AS REQUIRED AT LOW POINTS OF STRUCTURAL SLOPE TO PROVIDE POSITIVE DRAINAGE (SEE DETAIL 3/A5)
- OCJ OBSOLETE CONTROL JOINT. REMOVE ALL EXISTING WOOD BLOCKING
- Ⓜ OBSOLETE GAS PIPE. OWNER WILL REMOVE PRIOR TO ROOFING PROJECT
- SH EXISTING SMOKE HATCH (SEE DETAIL 2/A1.1)

NOTE:
 ROOF PLAN DOES NOT SHOW COMMUNICATION CABLES ON ROOF SURFACE (FIELD VERIFY). CONTRACTOR SHALL COORDINATE DOWNTIME AND/OR TEMPORARY CONNECTIONS WITH OWNER. COMMUNICATION SERVICES ARE VERY CRITICAL TO OWNER.

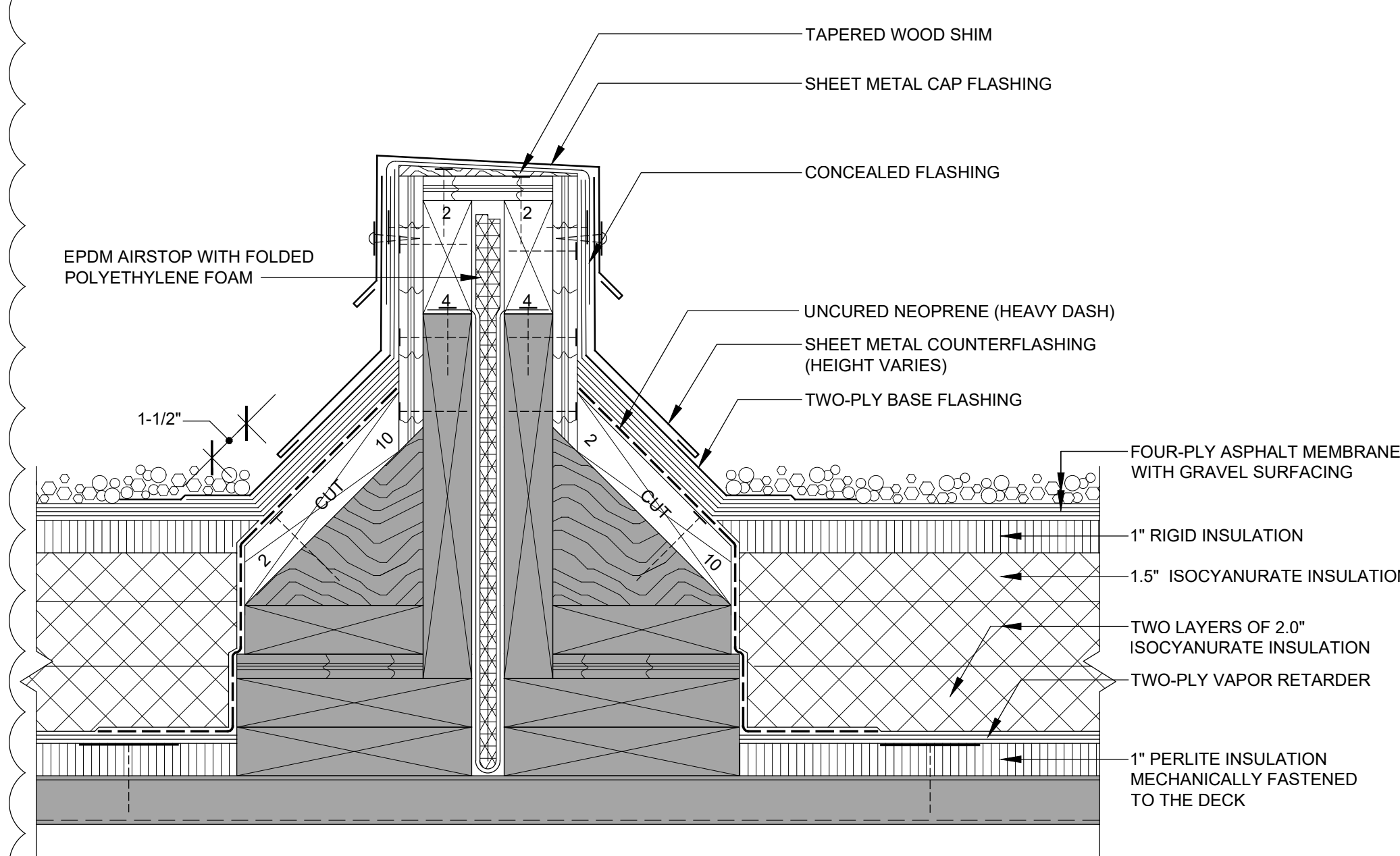
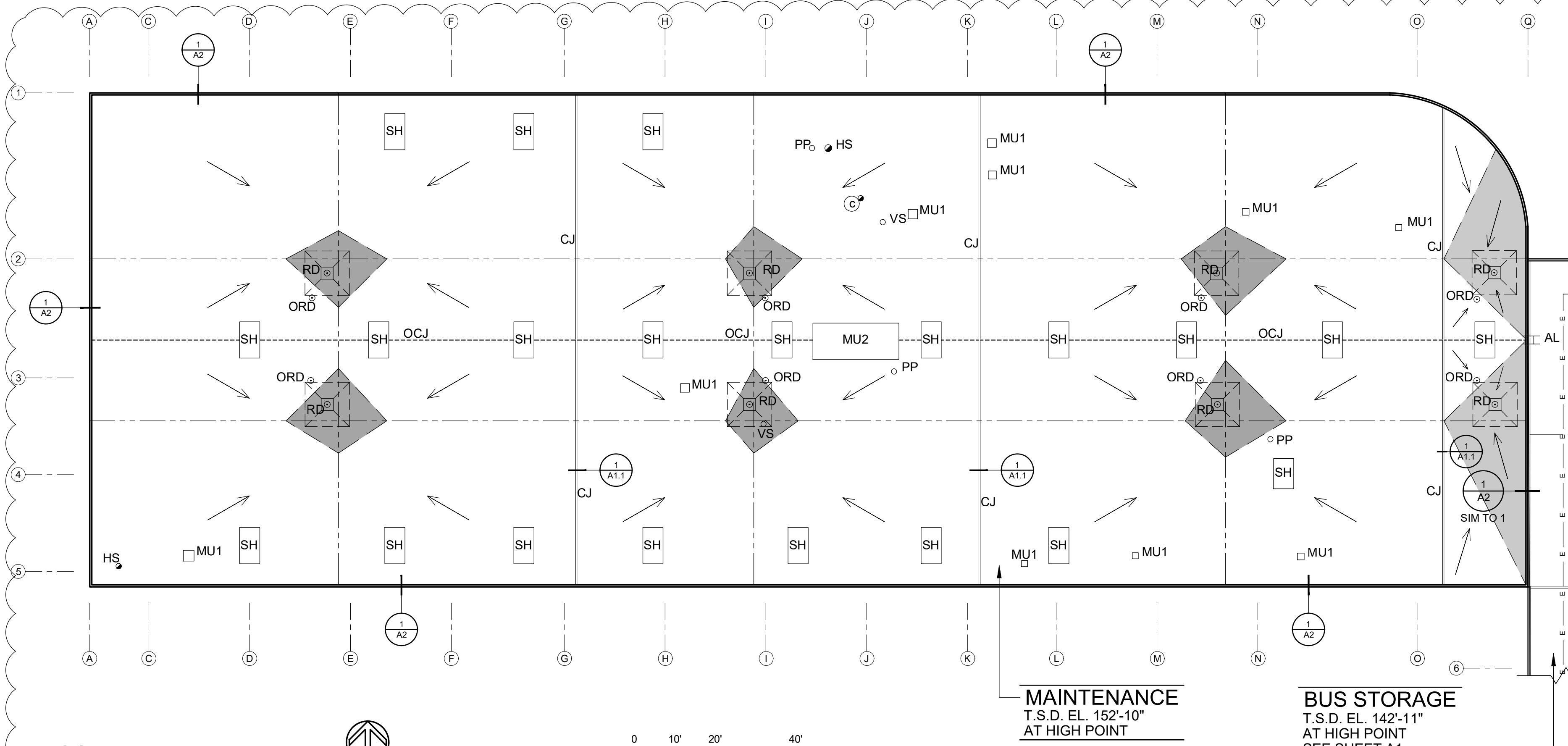

1 CONTROL JOINT DETAIL
 3" = 1'-0"

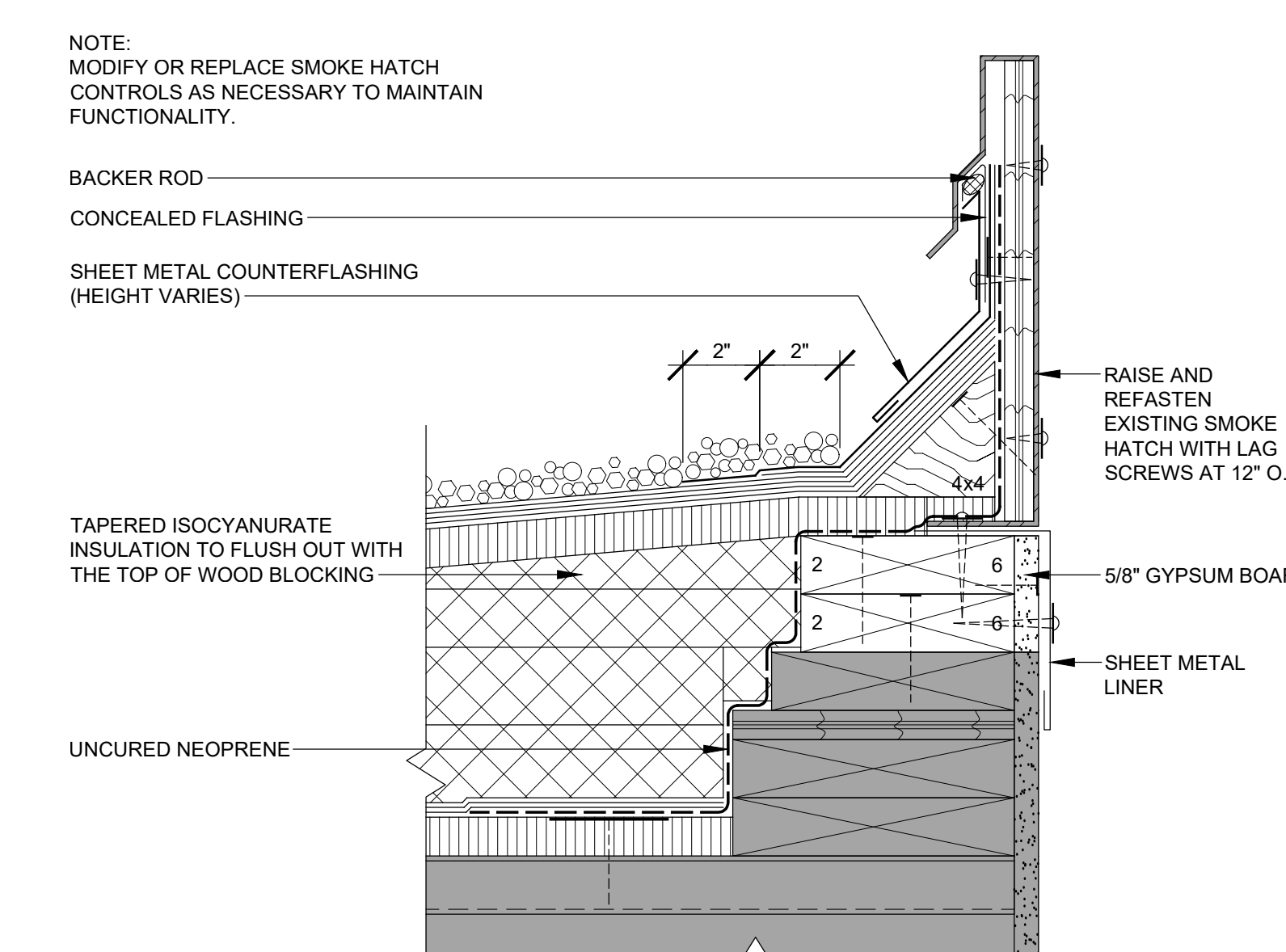

2 SMOKE HATCH DETAIL
 3" = 1'-0"

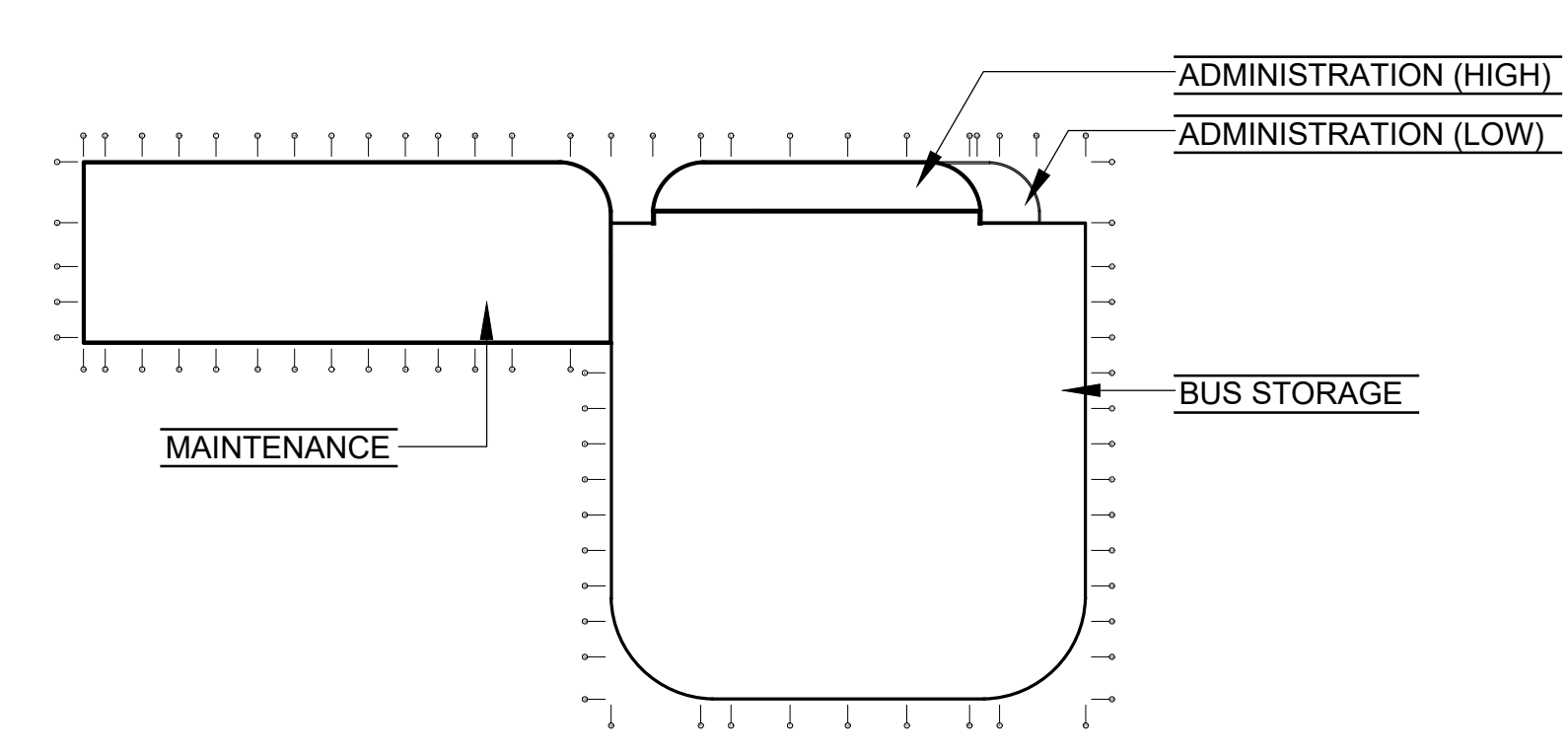

KEY PLAN
 NO SCALE
 PLAN NORTH
 TRUE NORTH

10/2019 2:42 PM RYAN MCLINN \\HUK\Roofing\Drawing Files\Public\Cities\City of Duluth\Duluth Transit Authority\2019 DTA Operations Center\5.0\inspec\0-CURRENT - use this one instead\Plan.dwg